

sb SELF BELAY

INSTALLTION MANUAL INSTALLING AND USING SELF BELAY CONNECTOR WITH KANOPEO SAFEROLLER AND HIROPE 2



safety
ENGINEERING

OFFICE ADDRESS:

111 Tsarigradsko shose,
1784 Sofia, Bulgaria
www.safetyeng.eu

ACCOUNTING DETAILS:

EUR: BG75UNCR70001520885679
USD: BG56UNCR70001523186764
Bank: UniCredit Bulbank AD
BIC code: UNCRBGSF
VAT number: BG 175376730



WARNING: Do not install or operate the device until you have fully read and fully understood this manual! FAILING TO DO SO MAY LEAD TO SERIOUS INJURIES OR FATALITIES!



Installing the Self Belay to the Hirope 2 User's Side Loop

1. Using a flat screwdriver remove the retaining E-clip:
2. With the screwdriver lift to unlock and remove the folding spring bolt:



3. Arrange the plastic spacers so that the chamfer is on the inside:



4. Align the Hirope 2 user's side loop between the spacers:

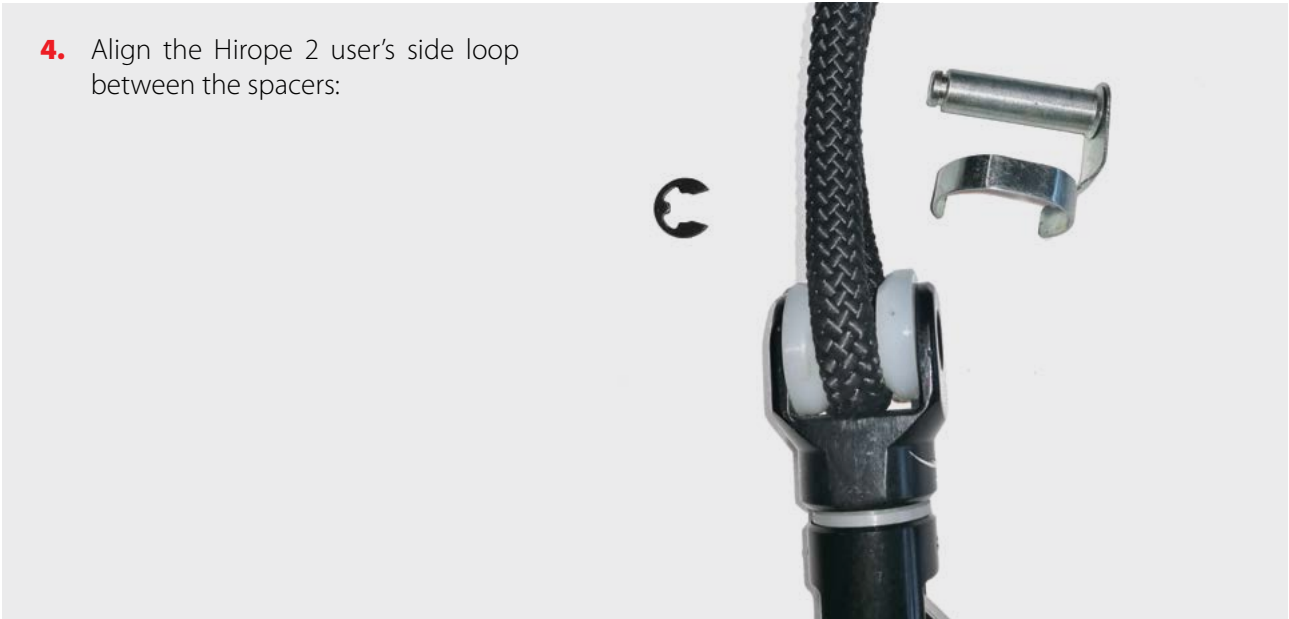

5. Insert back the folding spring bolt and lock it. Make sure you match the cone/tapered side of the swivel with the cone/tapered side of the bolt:

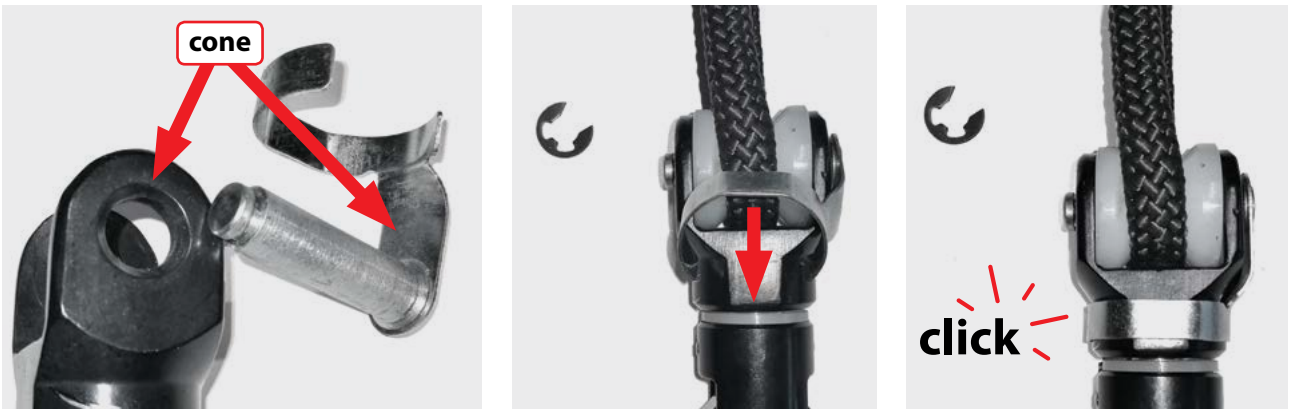

6. Using pliers lock back the retaining E-clip:

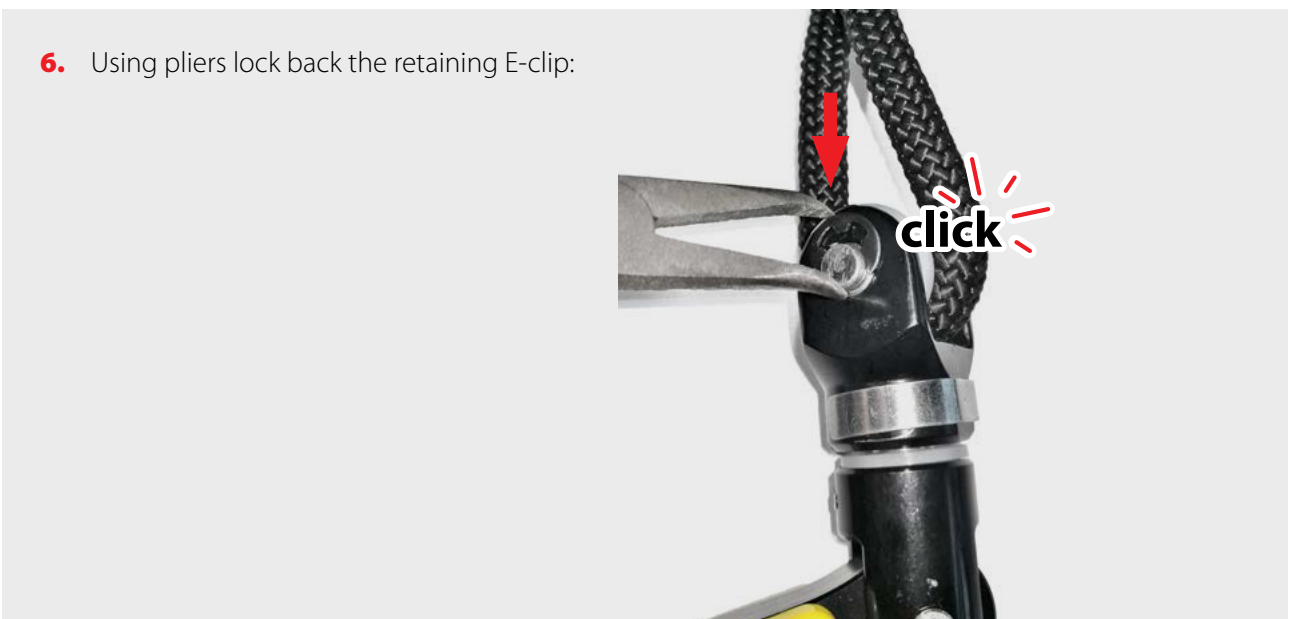

Installing Hirope 2 to the Saferoller

1. Insert the carabiner in the Saferoller eye. Use a rubber band or similar tool to avoid having the carabiner turn upside down:



2. Insert the lanyard loop first and then the Hirope 2 lock device:



Using Safety Engineering Self Belay connector with KANOPEO Saferoller and Hirope 2

WARNING: Always refer to the KANOPEO and Safety Engineering corresponding user manuals to fully understand how to properly operate each device. Failing to do so may lead to serious injuries or fatalities!

Make sure that the Hirope 2 is always in working position when in use:



To attach the customer to the Self Belay simply fully insert the harness piece in the Self Belay. Make sure it is locked:

To disconnect the customer use the Service key to unlock the device and remove the harness piece:

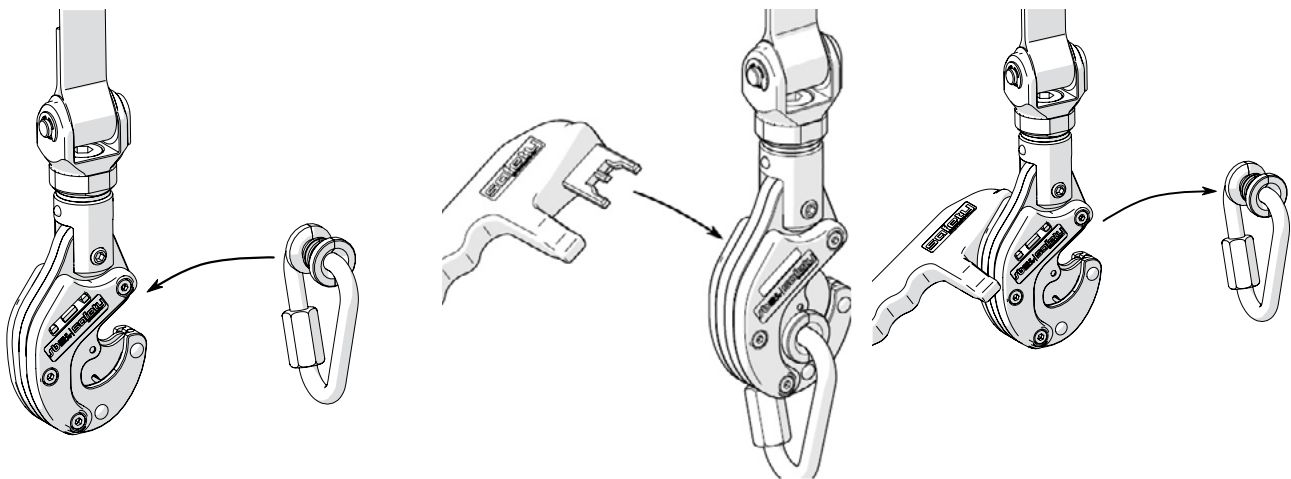

service



standard